

Rexpandit 20/40

Rexpandit 30/50

Classified fire protection joint elements for expansion joints
in **solid construction**



CLASSIFIED FIRE RESISTANCE

EI 120

DESCRIPTION / INTENDED USE

„Rexpandit“ is a joint element that foams up in the event of fire for the fire protection sealing of structural joints in walls or ceilings.

„Rexpandit 20/40“ and „Rexpandit 30/50“ consist of a compressible foam strip that is covered on the right and left with two layers of „Flaton-flex EN“, a building material that foams up in the event of fire.

„Rexpandit“ is elastic and compressible. The element is clamped into the joint during installation. The joint is immediately smoke-tight and sound-insulated.

In the event of fire, the outer layers of „Flaton-flex EN“ expand. The joints are filled by the material that forms. The foam strip is replaced by the intumescenting material. This creates an effective barrier that prevents the passage of fire, heat and smoke for at least 90 minutes.

PRODUCT RANGE

Designation	Length x Width x Filling Depth	Item number
Rexpandit 20/40	1250 x 48 x 60 mm	127035
Rexpandit 30/50	1250 x 58 x 60 mm	127036



Information on prices and packaging
packaging units on request.

TESTED JOINT DESIGNS / INSTALLATION CASES

Wall and ceiling joints, as well as **joints between ceilings and walls** with possible lateral expansion movement of max. 20 mm and additional possible shear movement of 25 mm in ceiling joints (see sketches on page 3):

Solid component to solid component in wall joints

Rexpandit 20/40	Joint width 20 mm with max. expansion by 20 mm to 40 mm joint width EI 120-V-M100-F-W 20
Rexpandit 30/50	Joint width 30 mm with max. expansion by 20 mm to 50 mm joint width EI 120-V-M66-F-W 30

Solid component to solid component in ceiling joints

Rexpandit 20/40	Joint width 20 mm with max. expansion of 20 mm to 40 mm joint width and additional possible shear movement of 25 mm EI 120-H-M136-F-W 20
Rexpandit 30/50	Joint width 30 mm with max. expansion of 20 mm to 50 mm joint width and additional possible shear movement of 25 mm EI 120-H-M86-F-W 30

Solid component

In horizontal and vertical constructions, the components must have a thickness of at least 150 mm and a bulk density of at least 650 kg / m³ ±200 kg/ m³.

INSTALLATION CASES ACCORDING TO DIN EN 1366-4

Installation case A: Joint sealing in ceiling construction

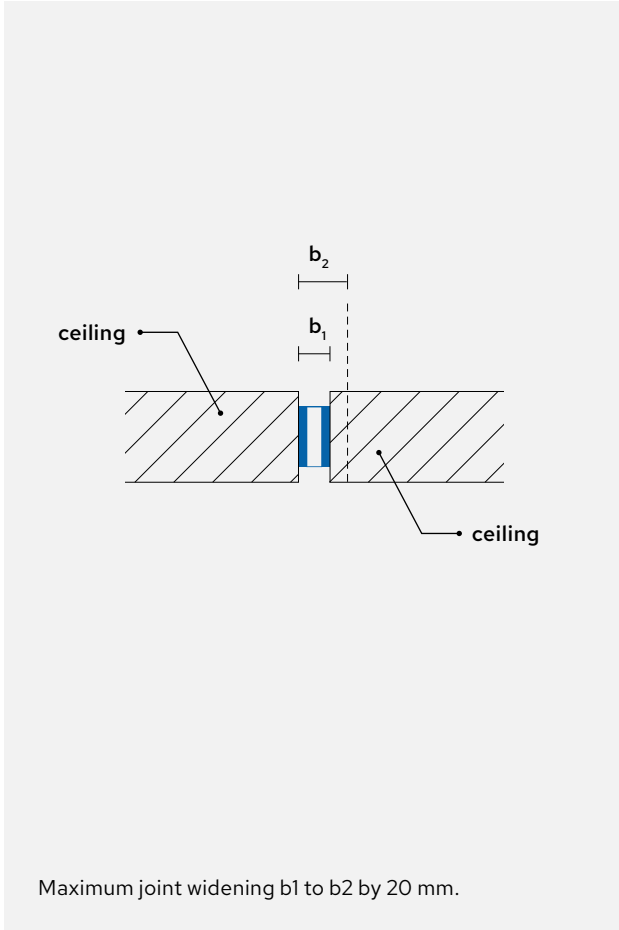

Installation case B: Joints between walls

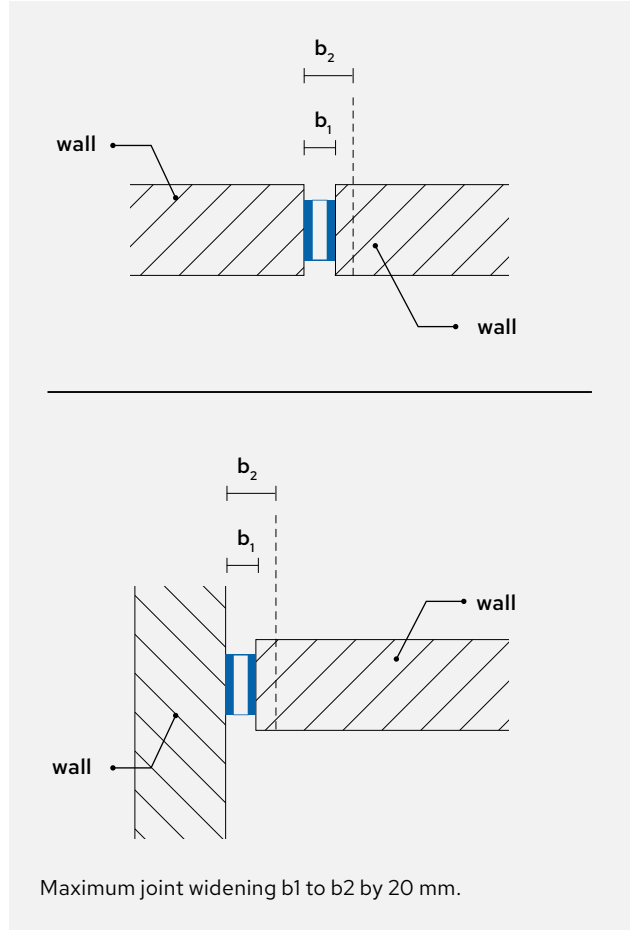

Installation case E: Horizontal joint between ceilings and walls

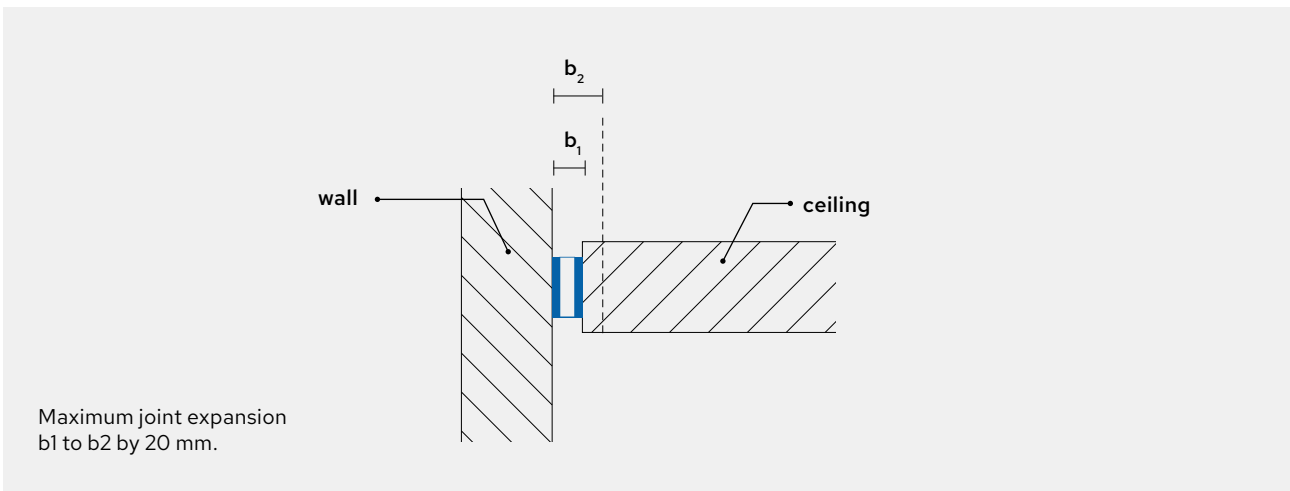

MATERIAL PROPERTIES

- „Rexpandit“ is classified in building material class C-s1, d0 according to DIN EN 13501-1:2019-05.
- „Rexpandit“ is sound-insulating.
The tested joint sound reduction index is:
 $R_{s,w} = 37.2$ dB for a 20 mm joint with „Rexpandit 20/40“
- The intumescent „Flaton-flex EN“ is halogen-, antimony-, silicone- and solvent-free. The foam is open-cell and has high sound absorption.
- The foam has good thermal insulation properties.
- It does not become brittle at low temperatures.
- The foam is manufactured without the use of halogenated hydrocarbons. The product is not hazardous to water.
- On delivery, Rexpandit is free of blowing agents and does not require labeling in accordance with the Hazardous Substances Ordinance.



Installation notes

Before installing „Rexpandit“, clean the inside edges of the joint.
Any existing formwork burrs, concrete splashes etc. must be removed.
„Rexpandit“ is simply compressed and pushed into the joint.
The end faces must be laid butt to butt. No further fixing is necessary.
Alternatively, „Rexpandit“ can also be applied to prefabricated elements during production after consultation.

We can send you classification reports and test certificates on request.

Rex Industrie-Produkte
Graf von Rex GmbH
Großaltdorfer Straße 59
74541 Vellberg
Tel. 07907 9620-0
info@rex-industrie-produkte.de

www.rex-industrie-produkte.de

The statements about specifications and data are made to the best of our knowledge. As far as possible, they have been verified by test certificates or determined by tests. In cases of doubt, we recommend carrying out a test adapted to the local conditions. Our sales and development staff are available to advise you at any time.

© All contents of this publication are protected by copyright. The copyright lies with Rex Industrie-Produkte Graf von Rex GmbH.
Subject to technical changes, typesetting and printing errors as well as color deviations due to printing technology.